

ahead RC Crawler

V306 Flatbed TRX4M

Assembly Manual

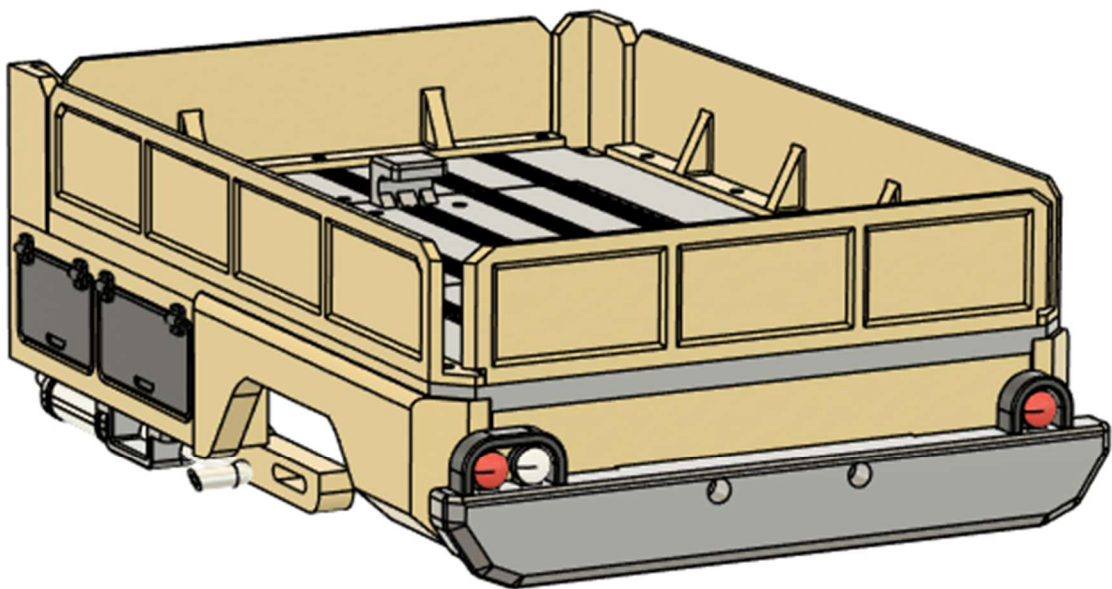

Required tools and hardware

Tools

- 1.5mm Hex Driver
- 2.0mm Hex Driver
- 2.5mm Hex Driver
- Needle Nosed Pliers
- Instant Glue
- Hot Glue

Electronics

- 3mm LED White x1
- 5mm LED Red x2

Hardware

Hardware	Quantity	Check
M2*5 Socket head	16	
M2*8 Socket head	14	
M2*8 Socket head (for wheels)	24	
M2*10 Socket head	9	
M2*12 Socket head	2	
M2.5*20 Socket head	4	
M3*20 Socket head	6	
10x2mm magnet	2	

Before you begin

- Be sure to read through the manual and familiarise yourself with the instructions
- Visualise a plan to assemble all the pieces
- Make sure you have all of the hardware and tools
- Be sure to have enough instant glue
- Dry fit all parts before painting and assembling

Tip: It will help to paint all of the parts before final assembly

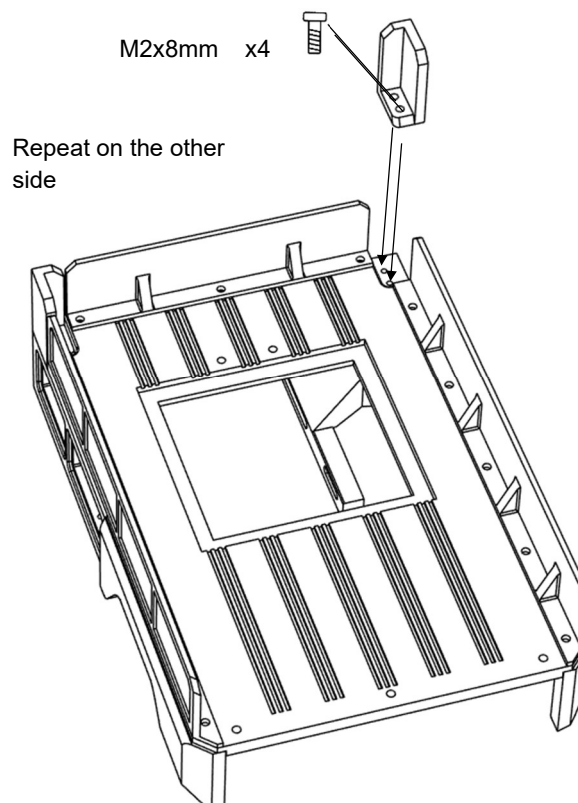
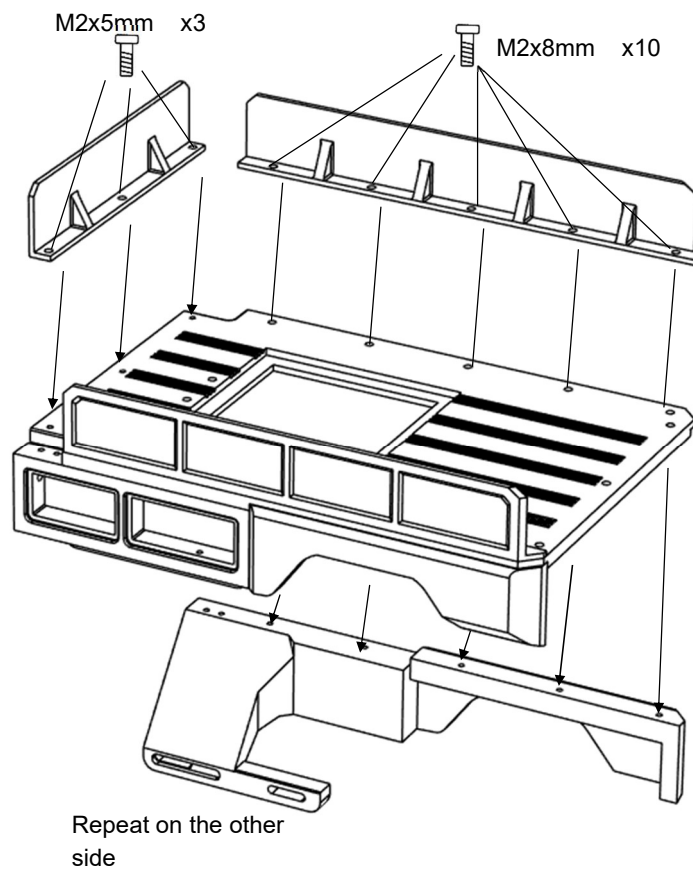

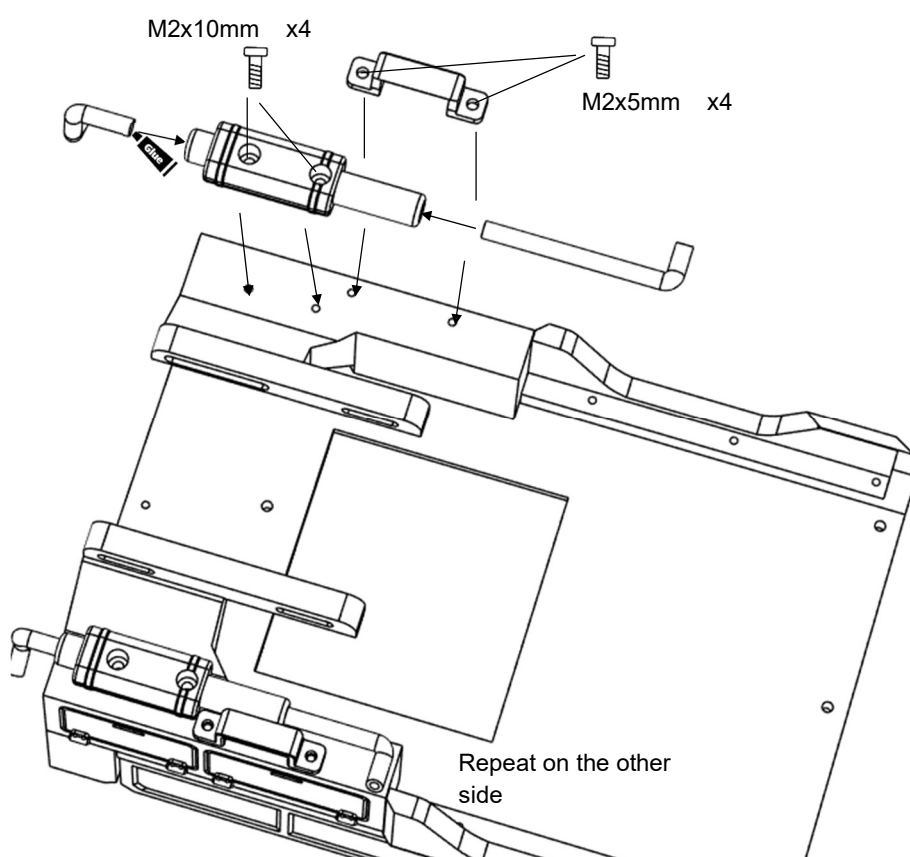
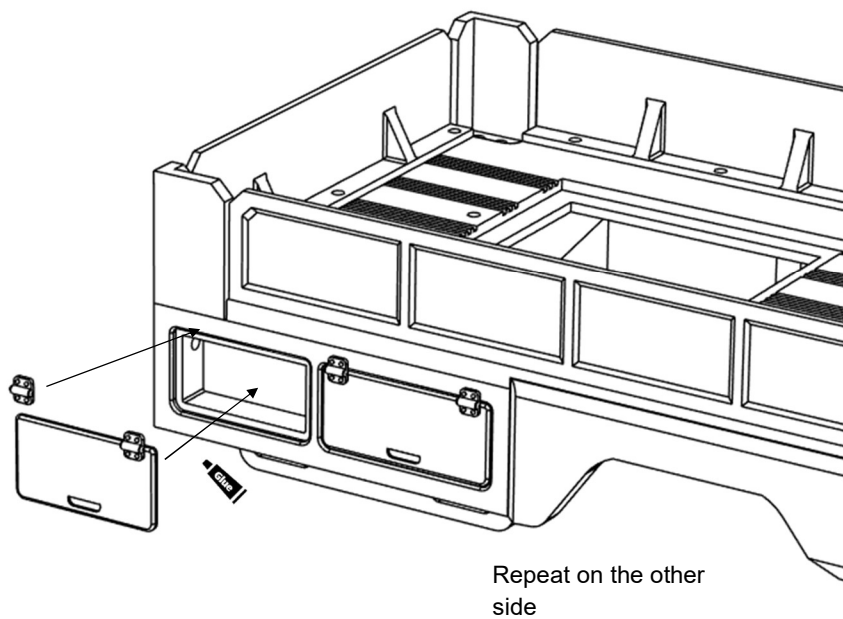

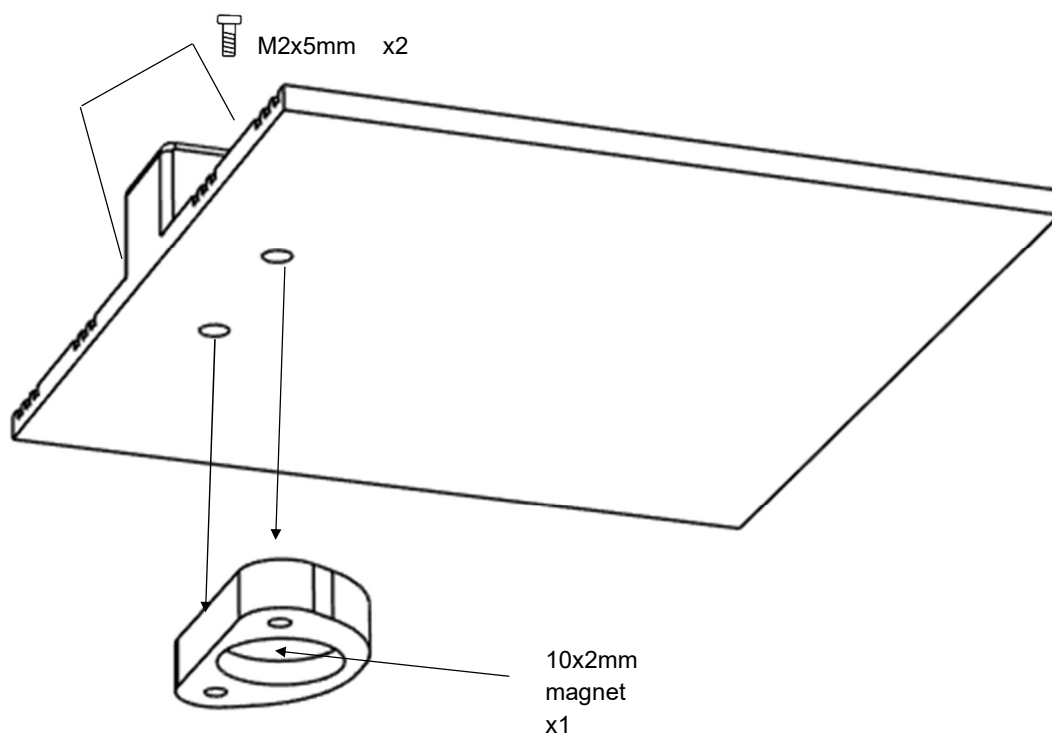
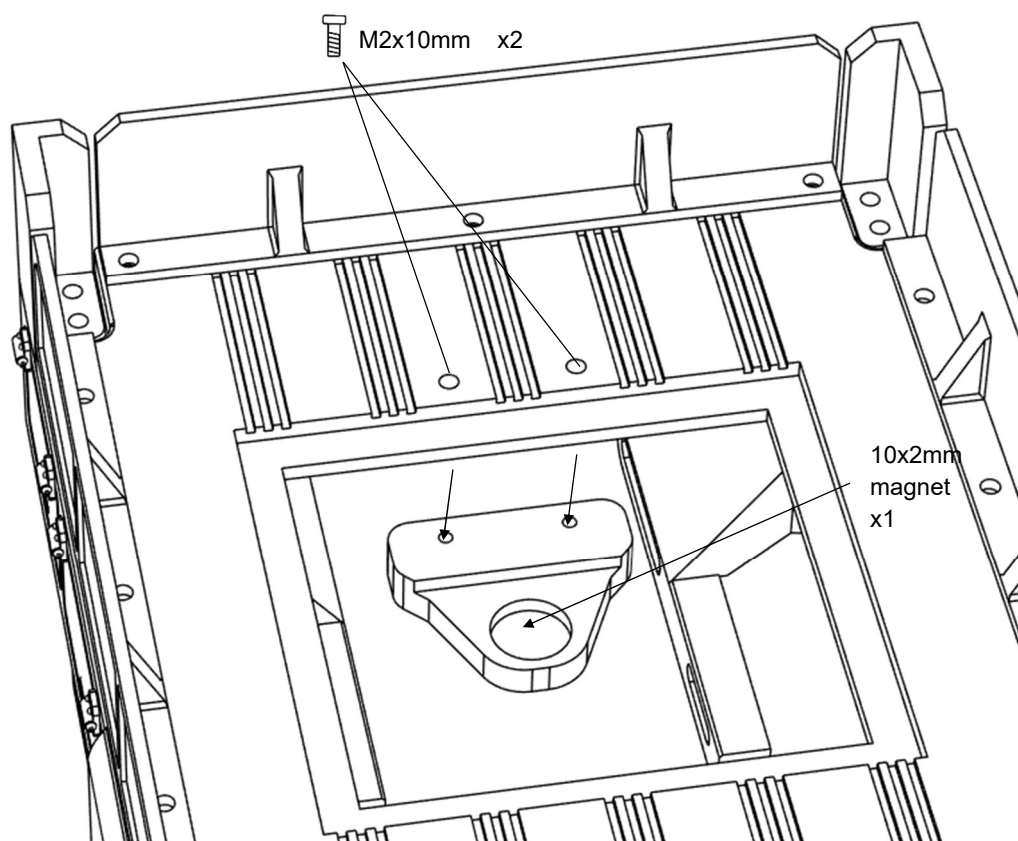

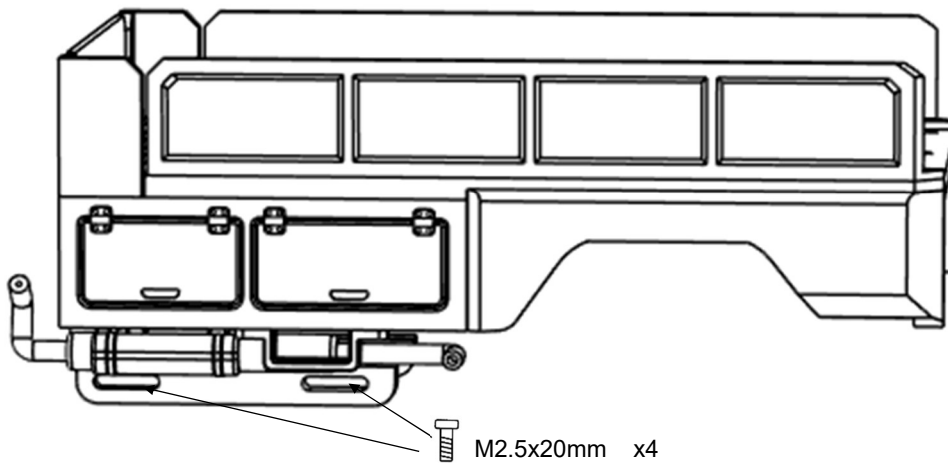
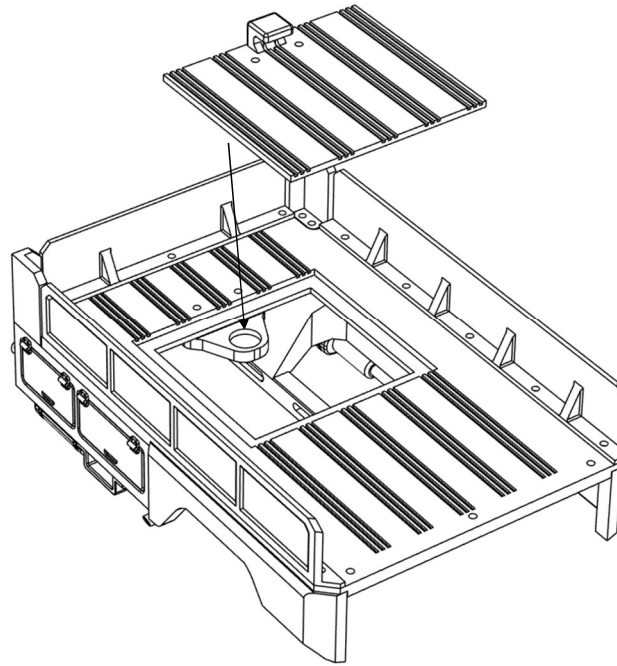

Repeat on the other side

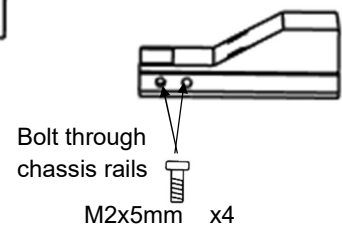

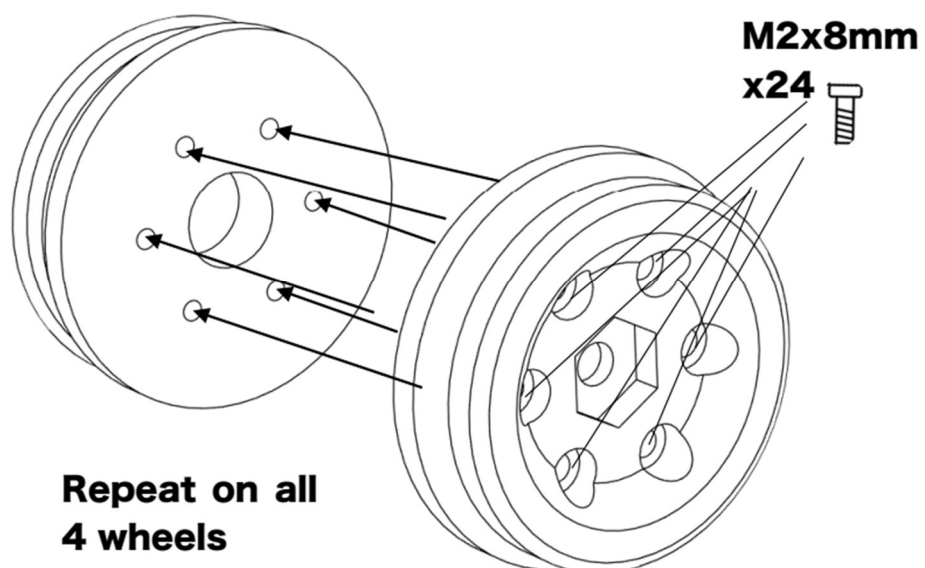
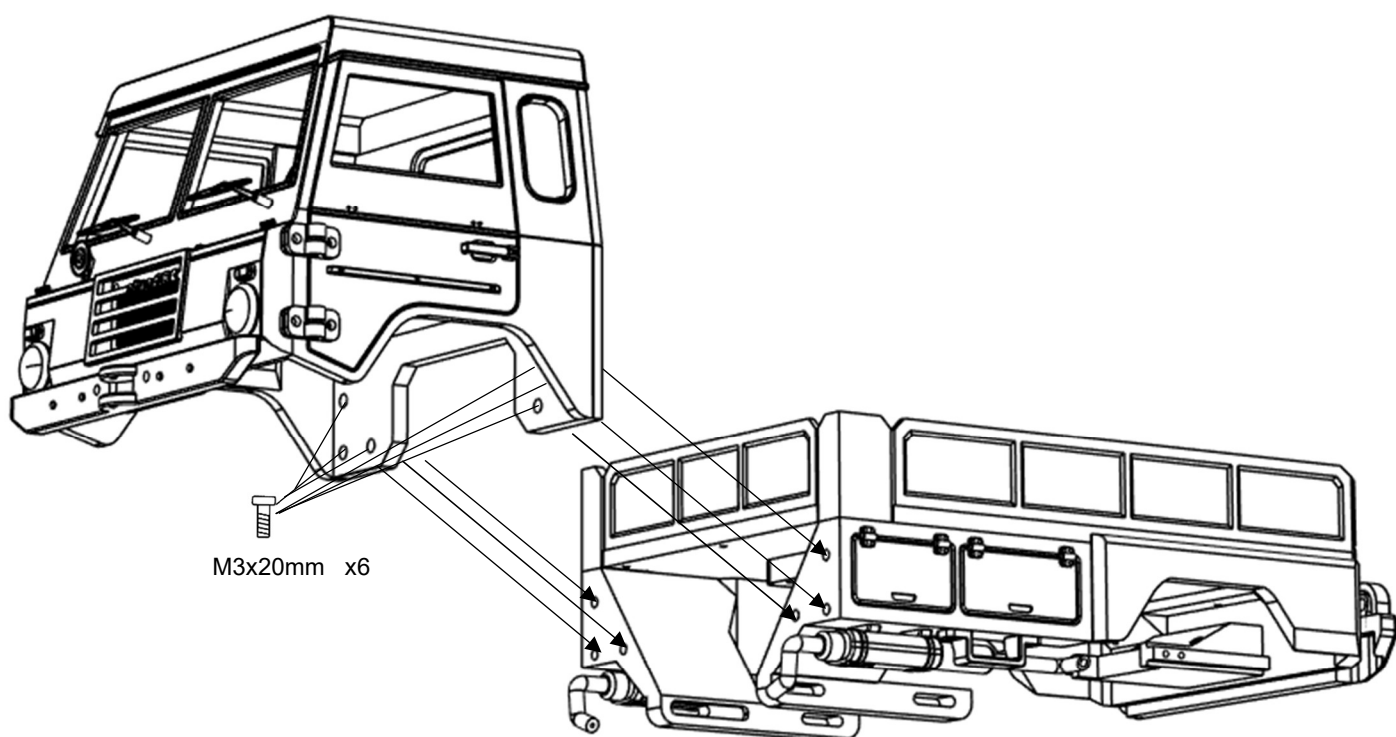

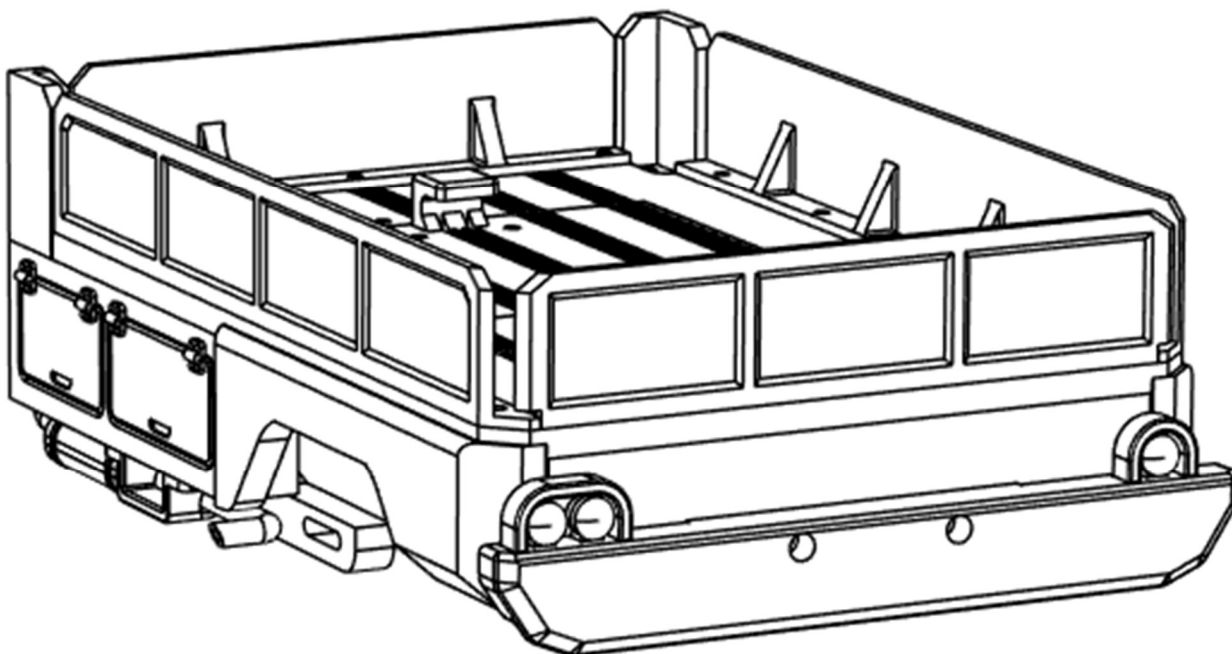

Body is now fully complete. Thank you for selecting ahead RC products.

If you have any questions or need help with the assembly, please do not hesitate to contact us at:

aheadrc@gmail.com

or visit us at:

www.aheadrc.com